

Brian Law's Wooden Clock 24 - Woodenclocks Gravity Escapement Version 3

Assembly Sequence

Stage 1 Assemble and glue all frame parts

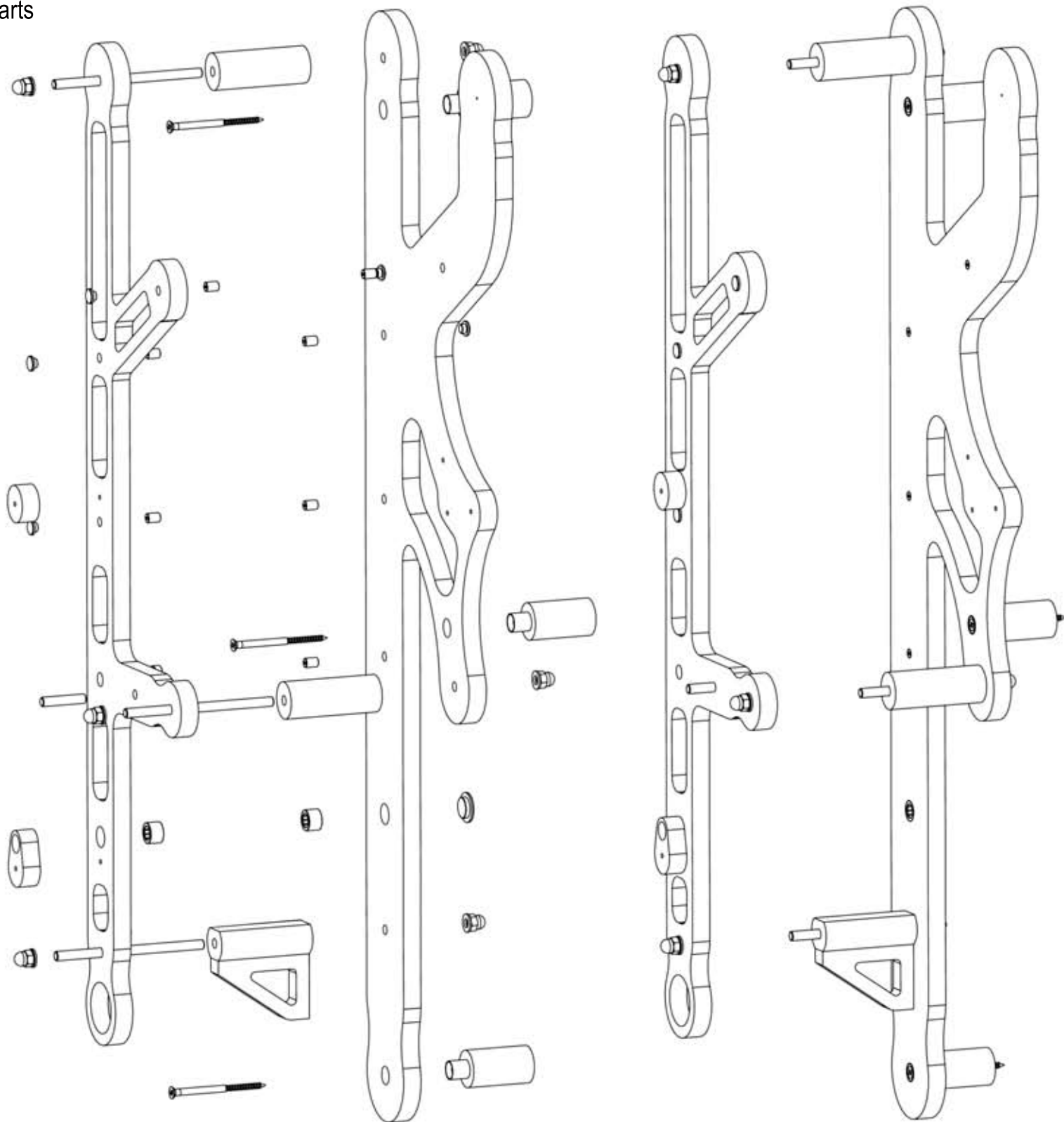

First stage is to fix and glue all the parts that are attached to the Front and Back frames. The bearing can be a tight press fit or be glued in place with Loctite. The Brace and the Spacers are glued to the Back Frame only. The wall spacers can be a tight fit in the Back frame or they can be glued. Fit all pins threaded rods and nuts and washers shown.

Brian Law's Wooden Clock 24 - Woodenclocks Gravity Escapement Version 3 Assembly Sequence

Stage 2 Assemble all Drive train sub assemblies

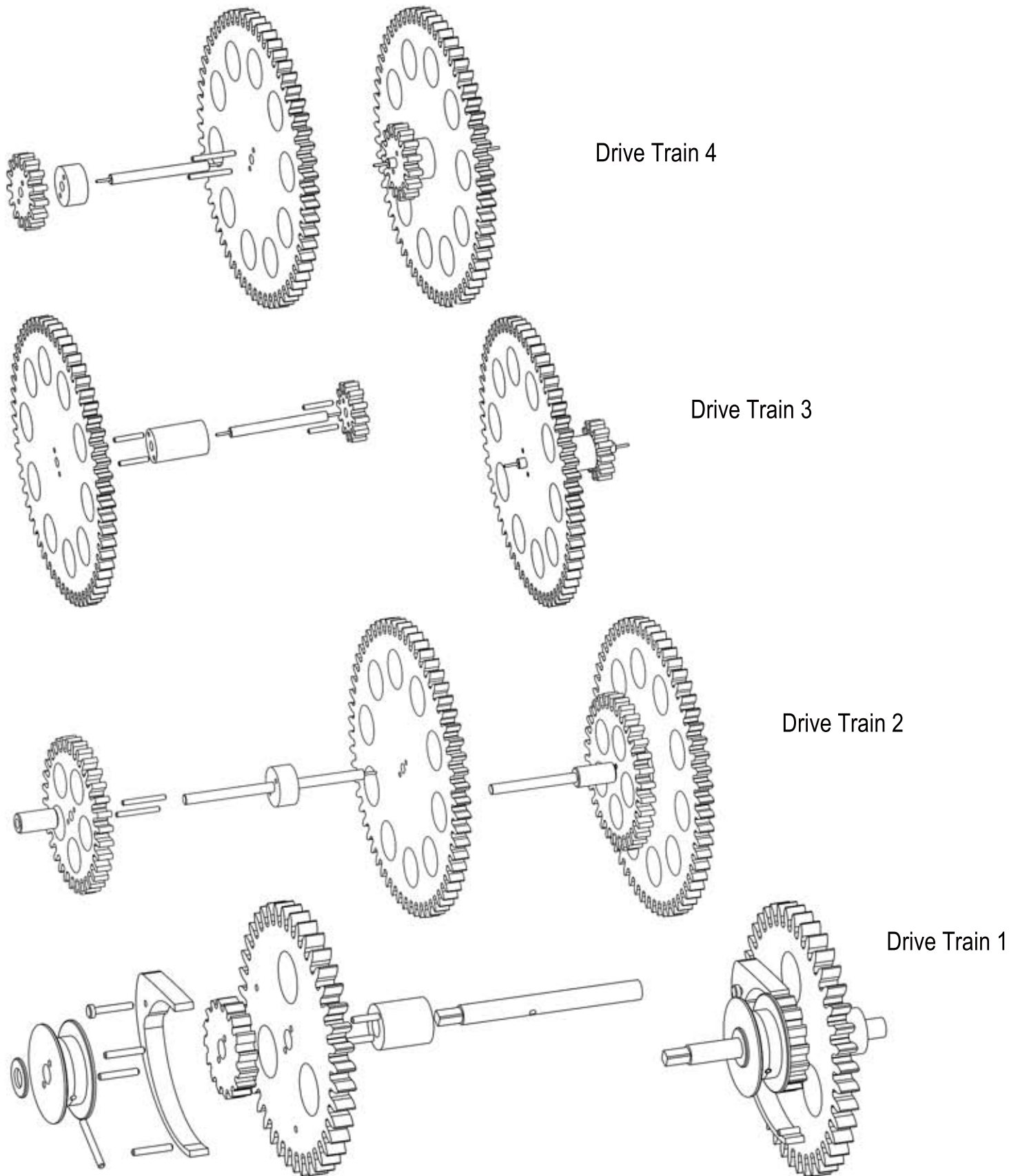

Assemble all Gear train Sub assemblies in accordance with the dimensions shown on the drawing Sheet .
The Drive Train 1 shown at the bottom should have the Drum and the Ratchet pinned to the shaft, the gear should turn freely and only be constrained by the ratchet from turning backwards.
The other three Drive Trains should have the parts a tight fit on the shaft.

Brian Law - July 2015

Brian Law's Wooden Clock 24 - Woodenclocks Gravity Escapement Version 3 Assembly Sequence

Stage 3 Assemble Escape Wheel

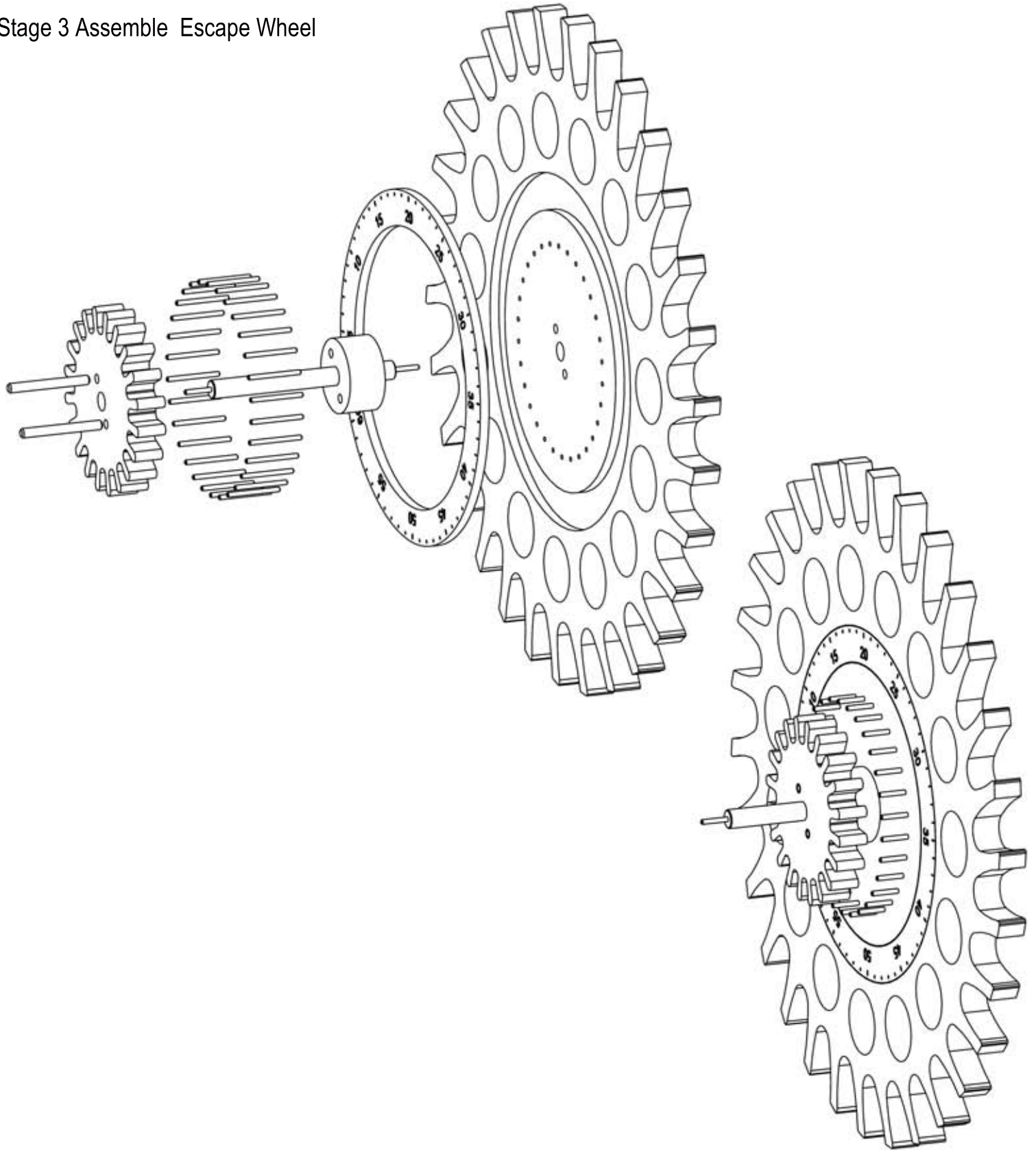

Assemble the Escape wheel assembly in accordance with the dimensions shown on the drawing Sheet
The Seconds ring can be stuck in with double sided tape, and if you drill a couple of holes through the groove you will be able to use a pin or blade to push it out again if fitted incorrectly.

Brian Law's Wooden Clock 24 - Woodenclocks Gravity Escapement Version 3

Assembly Sequence

Stage 4 Assemble all Drive train to Back frame

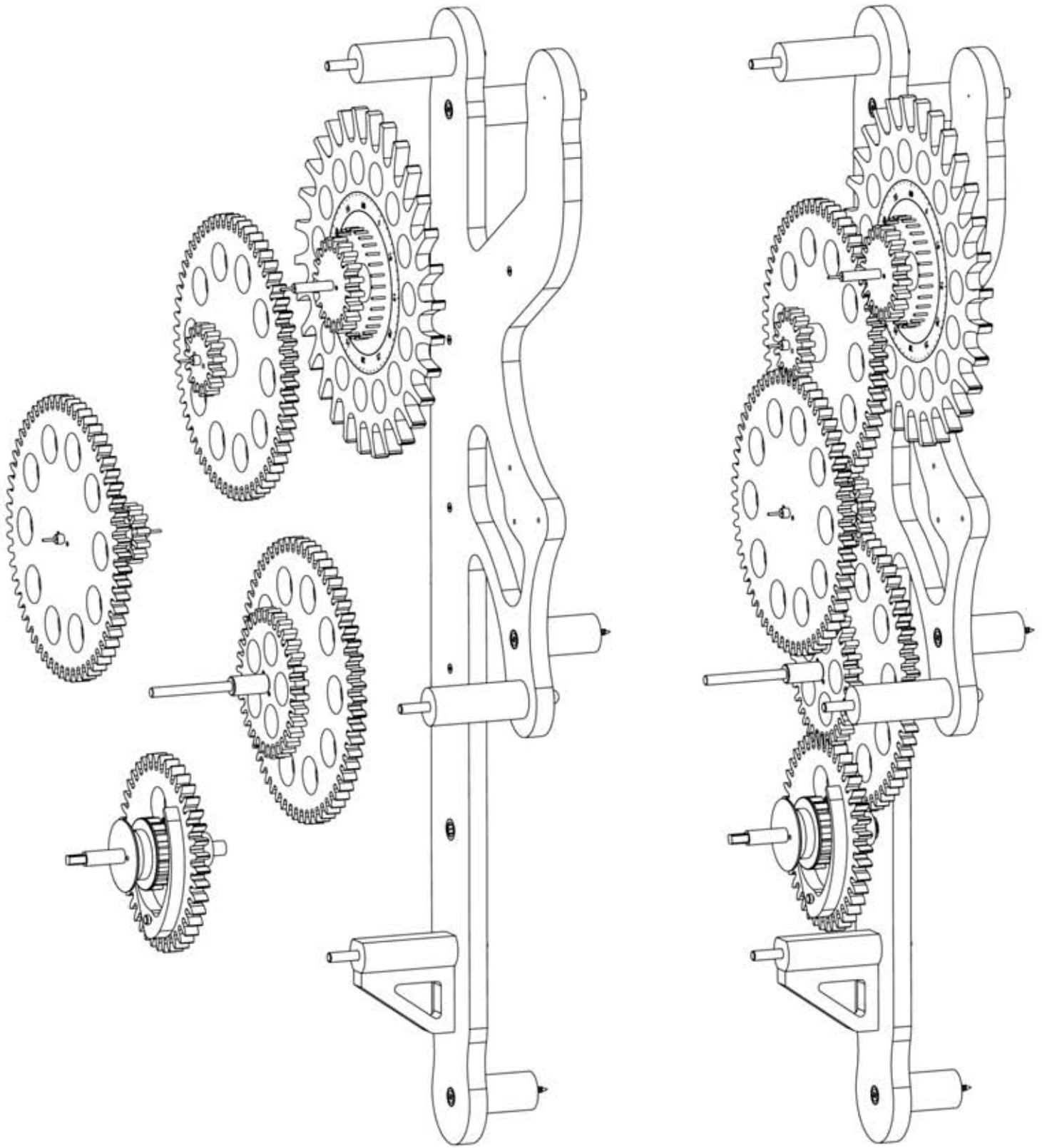

Fit the drive train gear sub assemblies to the back frame starting at the bottom, its actually easier to fit Drive Train 3 last as it sits above all the other gears.

Brian Law's Wooden Clock 24 - Woodenclocks Gravity Escapement Version 3 Assembly Sequence

Stage 5 Assemble the Escapement parts to the frame

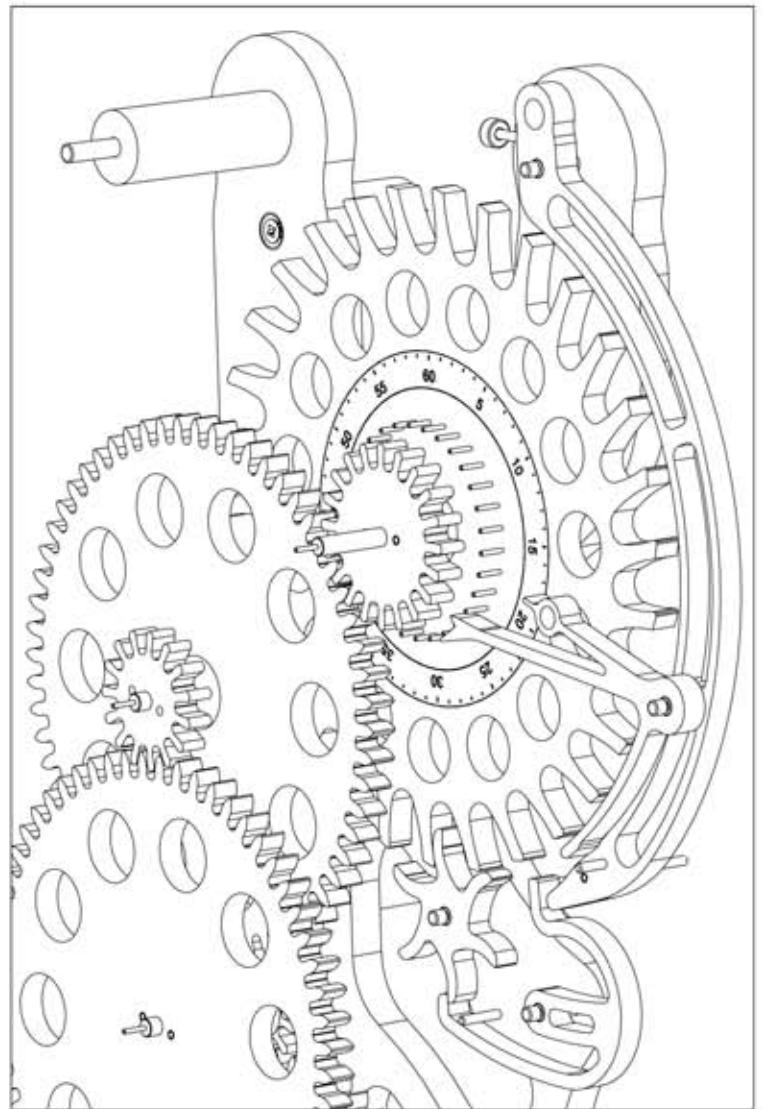
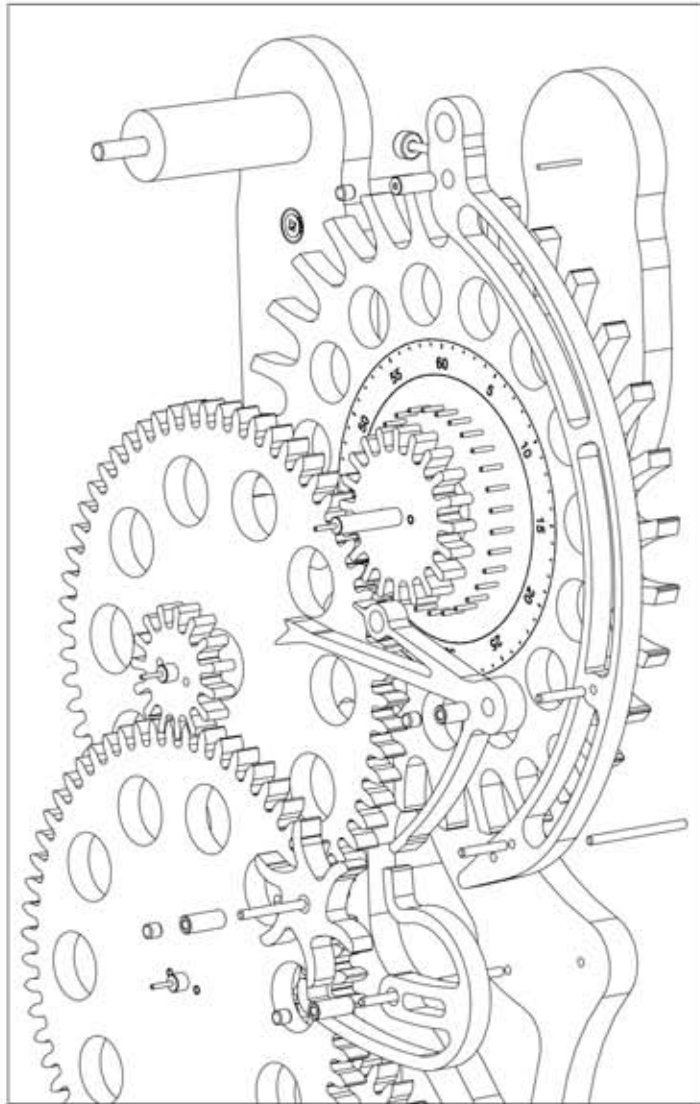

Fit all the bushes to the Gravity Arm, the Star, Lifting Arm and the Trigger . These bushes should be a tight fit in the Arm and the pins that fit through them should be a running fit in them. Fit the Impulse Pin and the triggers Stop Pin into the Gravity Arm and the pivot pins and the stop pin for the trigger into the back frame. Slide the gravity arm onto the the Pivot pin in the top of the back frame and rest the fork on the lifting arm onto one of the index pins in the escape wheel. Finally put a small magnet on the end of all the pivot pins to stop the parts falling off during operation.

Brian Law's Wooden Clock 24 - Woodenclocks Gravity Escapement Version 3 Assembly Sequence

Stage 6 Assemble Front frame and parts

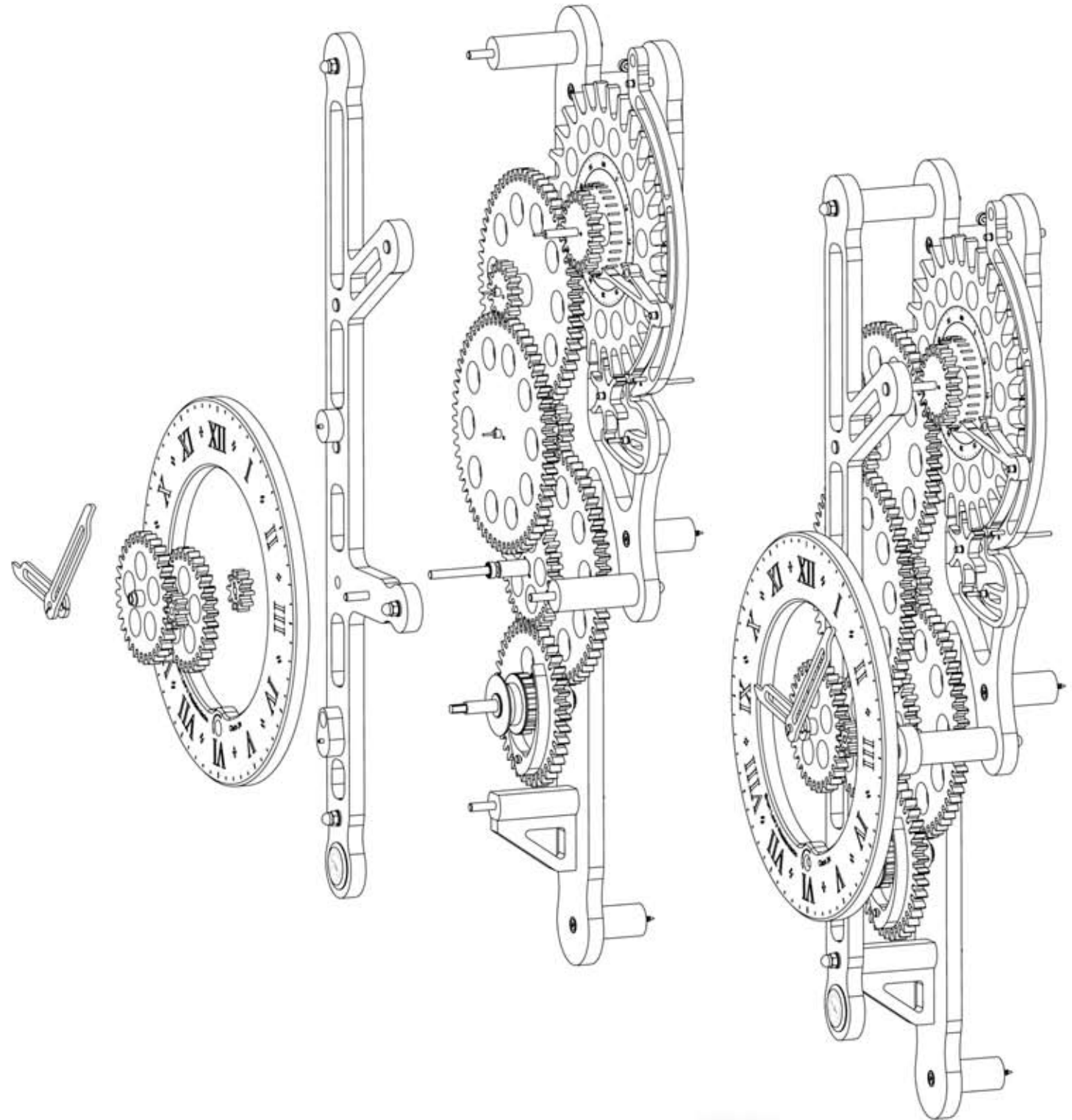

Fit the front frame taking care to align all of the shafts with the bearings and press down until the frame touches on the frame spacers. Secure with dined nuts and washers onto the threaded rods passed through the Frame spacers. Fit pendulum, Hands and hour gears and mount on the wall .

Brian Law's Wooden Clock 24 - Woodenclocks Gravity Escapement Version 3 Assembly Sequence

Stage 7 Typical fits required at all shafts.

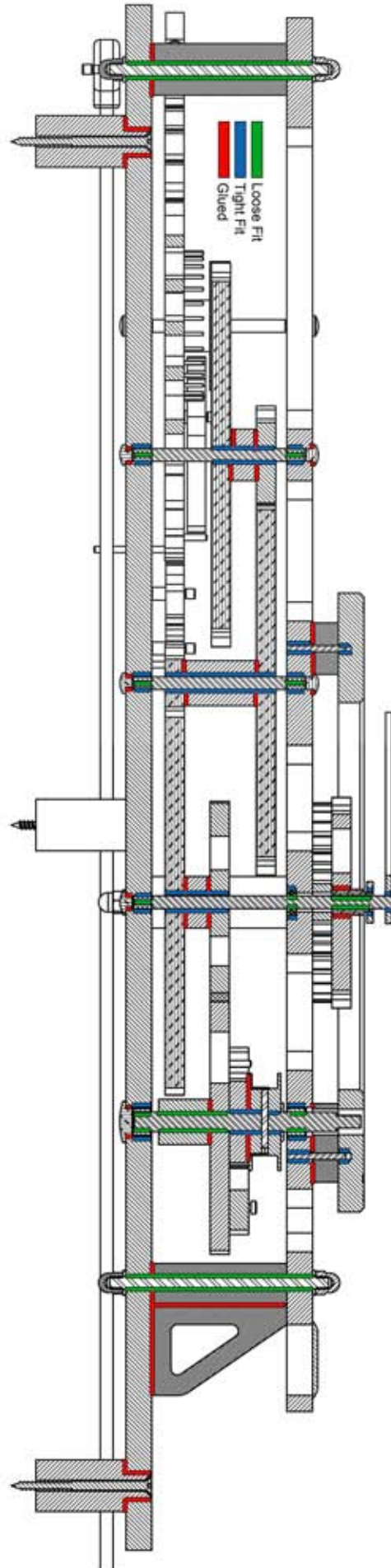

Brian Law's Wooden Clock 24 - Woodenclocks Gravity Escapement Version 3 Assembly Sequence

Stage 7 Assemble

Fit pendulum and mount on the wall .

Fit weight to cord using a loop tied with a Bowline knot and fitted to the weight as shown below.

Wind the clock, then set the pendulum swinging.

Fit the Punulum lock into the centre of the pendulum Bob, and slide onto the Pendulum Rod. You have to press the pendulum lock so it can line up with the rod before it will slip on. Chamfering the hole in the Pendulum lock will help this. The position of the Pendulum Bob can be adjusted by pressing the pendulum lock and sliding the Bob up, to speed up the clock and sliding down

