

She 1 of 2She A2

Clock 44 - Children's clock

Not to Scale
Unless otherwise stated

All dimensions in mm and (inches)
3rd Angle projection

August 2021

Designed by: Brian Iaw
www.woodenlocks.co.uk

ITEM NO.	PART NUMBER	DESCRIPTION	QTY.
1	Clock-44-Back frame	Wood 10 mm thk	1
2	Clock-44-Front frame	Wood 10 mm thk	1
3	Clock-44-Frame Spacer	Wood Ø20 mm x 71mm long	3
4	Clock-44-Frame Spacer-NF	Wood Ø20 mm x 71mm long	1
5	Clock-44-Top Brace	Wood 6 mm thick	1
6	Clock-44-Bottom Brace-RH	Wood 6 mm thick	1
7	Clock-44-Bottom Brace	Wood 6 mm thk	1
8	Clock-44-Wall Spacer	Wood Ø16 x 32 mm	2
9	Clock-44-Wall Spacer-Long	Wood 18mm x32mmx85mm	1
10	Clock-44-Escape wheel	Wood 6 mm thick	1
11	Clock-44-Gear-Spacer-22	Wood Ø12 x 22 mm	2
12	Clock-44-Shaft110	Steel Shaft Ø4 x 110mm	1
13	Clock-44-Pawl-Pin	Steel Ø2 mm x 12mm	6
14	Clock-44-Pin-Drum	Steel Ø2 mm x 29mm	1
15	Clock-44-Drive-Pin	Steel Ø2 mm x 32mm	2
16	Clock-44-Shaft-77	Steel Shaft Ø4 x 77mm	2
17	Clock-44-ODrive train pin	Steel Ø2 mm x 20 mm	1
18	Clock-44-Pivot Pin	Steel Shaft Ø4 x 49mm	1
19	Clock-44-4mm Bush	Brass Ø8 x 14mm	2
20	Clock-44-Drive-Shaft	Brass Ø8 mm x 99mm	1
21	Clock-44-Gears-11-Teeth	Wood 6 mm thk	1
22	Clock-44-Gear-64-Teeth	Wood 6 mm thk	1
23	Clock-44-Gears-12-Teeth	Wood 6 mm thk	1
24	Clock-44-Gear-Spacer-5	Wood Ø12 x 2 mm	1
25	Clock-44-Gear-Spacer-2	Plastic Ø8 x 2 mm	1
26	Clock-44-Gear-62-Teeth	Wood 6 mm thk	1
27	Clock-44-Gear-24-Teeth	Wood 6 mm thk	1
28	Clock-44-Winder-Spacer	Wood Ø16 mm	1
29	Clock-44-Ratchet	Wood 6mm thk	1
30	Clock-44-shaft-spacer-Back	Wood Ø16 mm	1
31	Clock-44-shaft-spacer-Front	Wood 6 mm thk	1
32	Clock-44-Drum	Wood 20mm thk OR 2x10mm thk	1
33	Clock-44-Gears-48-Teeth	Wood 8mm thk	1
34	Clock-44-Winder-Shaft-Pawl	Wood 6mm thk	3
35	Clock-44-Weight Cord	Blind Cord Ø0.5 mm	1
36	Clock-44-Weight-Bottom	Brass Ø38 x 110 mm	1
37	Clock-44-Weight Hanger pin	Brass Ø6	2
38	Clock-44-Endstop-4mm	Plastic Ø8 x 2 mm	3
39	Clock-44-Pendulum Pivot Block	Wood 12 mm thk	1
40	Clock-44-Pendulum Rod	Carbon Fibre tube Ø6 x 1100 mm	1
41	Clock-44-Pendulum-Connect-Pin	Steel Ø3 mm x 31mm	2
42	Clock-44-Pendulum Bob Centre	Wood 6mm thk	1
43	Clock-44-Pendulum Bob Bottom	Wood 6mm thk	1
44	Clock-44-Pendulum Bob Weight	Brass Ø16	2
45	Clock-44-Pendulum Bob Top	Wood 6mm thk	1

ITEM NO.	PART NUMBER	DESCRIPTION	QTY.
46	Clock-44-Pendulum Bob Lock	Wood 6mm thk	2
47	Clock-44-Pendulum Bob Pin	Steel Ø2x18mm	6
48	Clock-44-Pendulum Rod end	Plastic Ø12	1
49	Clock-44-Escapement arm	Wood 6mm thk	1
50	Clock-44-Pallet	Plastic 1mm thk	2
51	Clock-44-Pallet-clamp	Wood 6mm thk	2
52	Clock-44-Numeral 12	Wood or Plastic 4 mm thk	1
53	Clock-44-Dial base	Wood 7mm thk	1
54	Clock-44-Numeral 1	Wood or Plastic 4 mm thk	1
55	Clock-44-Numeral 2	Wood or Plastic 4 mm thk	1
56	Clock-44-Numeral 3	Wood or Plastic 4 mm thk	1
57	Clock-44-Numeral 4	Wood or Plastic 4 mm thk	1
58	Clock-44-Numeral 5	Wood or Plastic 4 mm thk	1
59	Clock-44-Numeral 6	Wood or Plastic 4 mm thk	1
60	Clock-44-Numeral 7	Wood or Plastic 4 mm thk	1
61	Clock-44-Numeral 8	Wood or Plastic 4 mm thk	1
62	Clock-44-Numeral 9	Wood or Plastic 4 mm thk	1
63	Clock-44-Numeral 10	Wood or Plastic 4 mm thk	1
64	Clock-44-Numeral 11	Wood or Plastic 4 mm thk	1
65	Clock-44-Hour-Gears-9-Teeth	Wood 6mm thk	1
66	Clock-44-Hour-Gears-10-Teeth	Wood 6mm thk	1
67	Clock-44-Hour-Gears-30-Teeth	Wood 6mm thk	1
68	Clock-44-Hour-Gears-32-Teeth	Wood 6mm thk	1
69	Clock-44-Hour-Tube	Wood Ø10 x 18 mm	1
70	Clock 44-Hour-Gear_pivot	Steel Ø4 mm x 21 mm	1
71	Clock-44-Minute Hand	Plastic 3 mm thk	1
72	Clock-44-Hour Hand	Plastic 3 mm thk	1
73	M3 HEX NUT		2
74	90116A169	Pan Headed Screw 3 x 20 mm	2
75	M3-WASHER		2
76	Clock-44-dial Pin 3-15	Steel pin Ø3	2
77	Woodscrew-long	Brass No8x 65 mm	3
78	BALL BEARING-4-10-4	MF104ZZ 4X10X4mm	6
79	BALL BEARING-8-14-4	MF148ZZ 8X14X4mm	2
80	M8 Threaded rod	Steel M6 x 101 mm	4
81	M6-Washer	Brass or Delrin	8
82	Domed nut-m6	M6 Domed Nut	8

SH 2 of 28ths A2

Clock 44 - Childrens clock

Not to Scale
Unless otherwise stated

All dimensions in mm and (inches)
3rd Angle projection

August 2021

Designed by: Brian law
www.woodclocks.co.uk

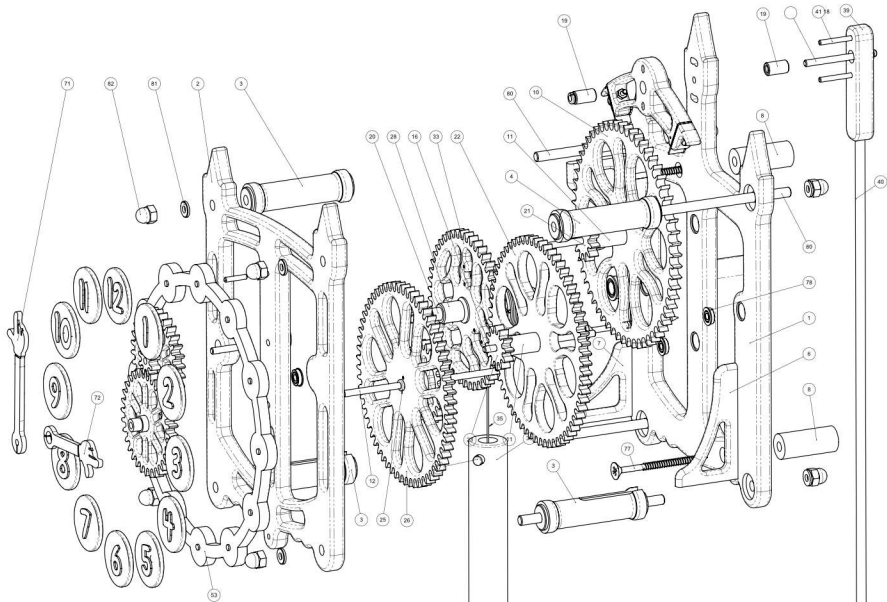

Size: 4 x 125mm A2

Clock 44 - Children's clock

Not to Scale
Unless otherwise stated

All dimensions in mm and (inches)
3rd Angle projection

August 2021

Designed by: Brian Iain
www.epicclocks.co.uk

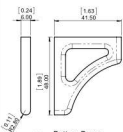

7 Bottom Brace
Wood
Scale 1:1

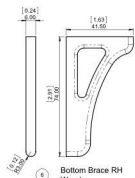

8 Bottom Brace RH
Wood
Scale 1:1

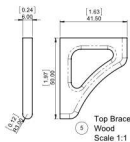

5 Top Brace
Wood
Scale 1:1

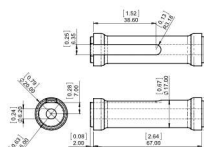

2 Frame Spacer
Wood 3 Required
Scale 1:1

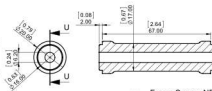

4 Frame Spacer-NF
Wood 1 Required
Scale 1:1

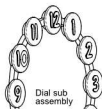

Dial sub
assembly

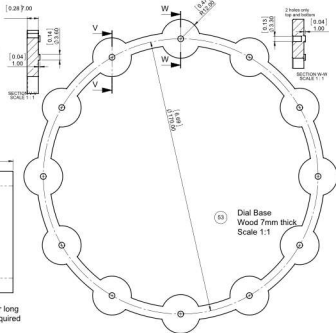

58 Dial Base
Wood 7mm thick
Scale 1:1



54 Numerals 1
Wood
Scale 1:1



56 Numerals 2
Wood
Scale 1:1



58 Numerals 3
Wood
Scale 1:1



57 Numerals 4
Wood
Scale 1:1



58 Numerals 4
Wood
Scale 1:1



58 Numerals 4
Wood
Scale 1:1



60 Numerals 4
Wood
Scale 1:1



61 Numerals 4
Wood
Scale 1:1



62 Numerals 4
Wood
Scale 1:1



63 Numerals 4
Wood
Scale 1:1



64 Numerals 4
Wood
Scale 1:1



62 Numerals 4
Wood
Scale 1:1

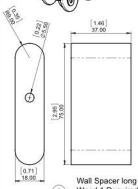

8 Wall Spacer long
Wood 1 Required
Scale 1:1



9 Wall Spacer
Wood 2 Required
Scale 1:1

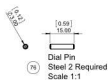

76 Dial Pin
Steel 2 Required
Scale 1:1

All numbered disks have a 04 mm hole in the back to fit on the spigots protruding from the Dial Base.
The Discs are drawn here with the numbers protruding so they need to be machined separately and glued to the surface of the disk or machined into the disk using a V bit.

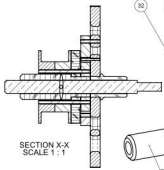
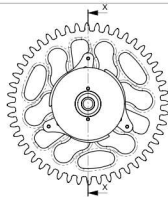

SECTION X-X
SCALE 1:1

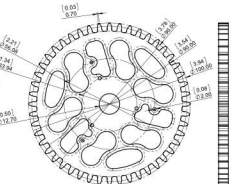
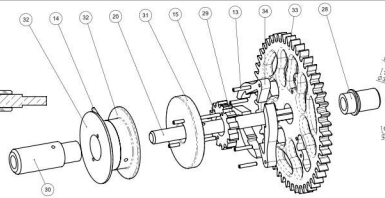

33 Gear 48 Teeth Wood
Scale 1:1

Drive Assembly

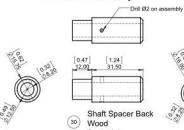

30 Shaft Spacer Back Wood
Scale 1:1

28 Winder Spacer Wood
Scale 1:1

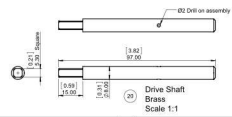

23 Drive Shaft Brass
Scale 1:1

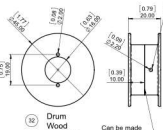

32 Drum Wood
Scale 1:1

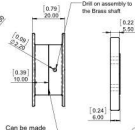

15 Pin Drum Steel 2 Required
Scale 1:1

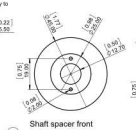

31 Shaft spacer front Wood
Scale 1:1

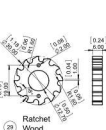

29 Ratchet Wood
Scale 1:1

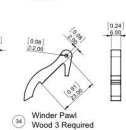

34 Winder Pawl Wood 3 Required
Scale 1:1

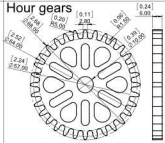

68 Hour Gear 32 Teeth Wood
Scale 1:1

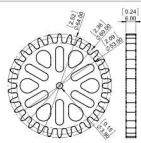

67 Hour Gear 30 Teeth Wood
Scale 1:1



65 Hour Gear 8 Teeth Wood
Scale 1:1

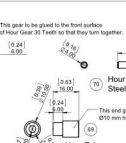

66 Hour Gear 10 Teeth Wood
Scale 1:1



70 Hour Gear Pivot Steel
Scale 1:1

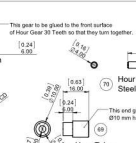

68 Hour Tube Wood
Scale 1:1



71 Minute Hand Plastic
Scale 1:1



72 Hour Hand Plastic
Scale 1:1

Sh# 8 of 25hts A2
Not to Scale
Unless otherwise stated

Clock 44 - Childrens clock
All dimensions in mm and (inches)
3rd Angle projection

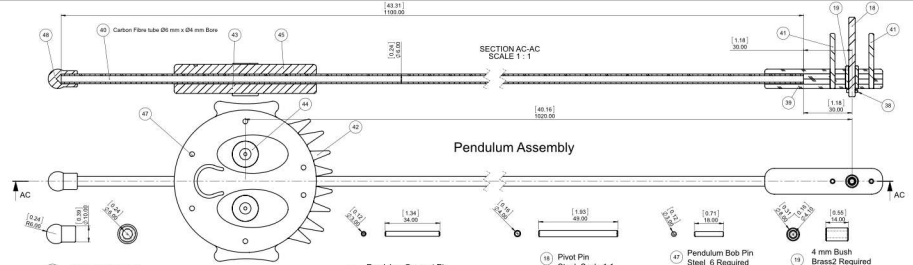

48 Pendulum Rod End Plastic Scale 1:1

41 Pendulum Connect Pin Steel 2 required Scale 1:1

18 Pivot Pin Steel Scale 1:1

47 Pendulum Bob Pin Steel 6 Required Scale 1:1

19 4 mm Bush Brass 2 Required Scale 1:1

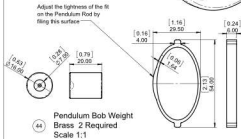
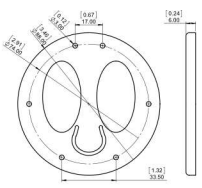
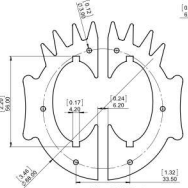
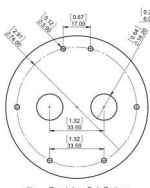
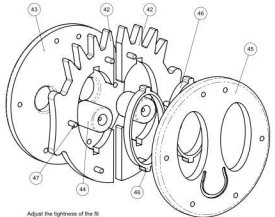

Pendulum Bob Lock Plastic or Wood 2 Required Scale 1:1

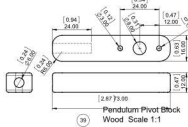

38 Pendulum Bob Lock Plastic 3 Required Scale 1:1

 Loose Fit
 Tight Fit
 Glued

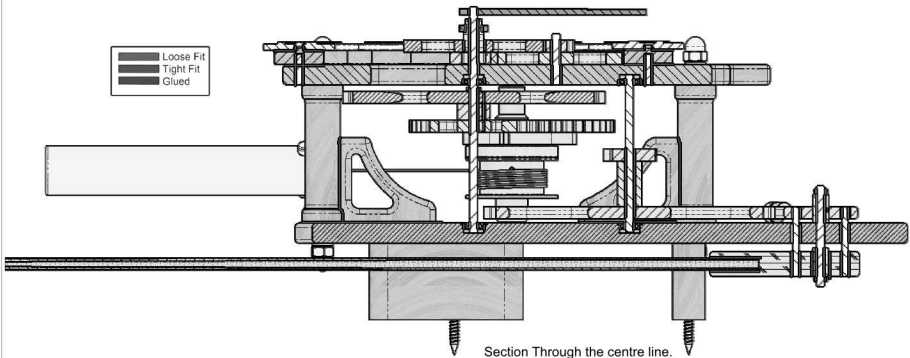

Section Through the centre line.